









CODICE · ITEM NO. ARTIKEL NR. · RÉFÉRENCE	DESCRIZIONE · DESCRIPTION EZEICHUNG · DESCRIPTION	PAGINA · PAGE SEITE · PAGE	
9020	Pg - YMW NORM STR HSSE	231	
STI-HT	M, MF - JIS HT HSSE	232	
STI-SP	M, MF - JIS SP35° HSSE	232	

-  **MASCHI A MACCHINA PER FORI CIECHI E PASSANTI**
-  **BLIND AND THROUGH HOLES MACHINE TAPS**
-  **MASCHINENGEWINDEBOHRER FÜR DURCHGANGS-UND GRUNDLÖCHER**
-  **TARAUDS MACHINE POUR TROUS BORGNES ET DÉBOUCHANTS**

Pg
 YMW NORM

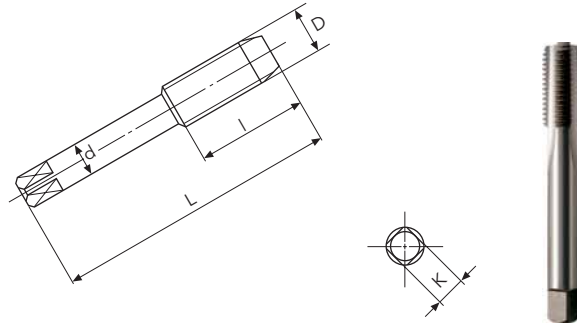

GRUPPI MATERIALE · MATERIAL GROUPS								1 2 3 4 5
WERKSTOFFE GRUPPE · GROUPES MATIÈRE								12 13 14 17
CODICE / ITEM NO. / ARTIKEL NR. / RÉFÉRENCE								9020
TIPO / TYPE / TYP / TYPE								STR
MATERIALE / MATERIAL / WERKSTOFF / MATIÈRE								HSSE
RIVESTIMENTO / COATING / BESCHICHTUNG / REVÊTEMENT								BR
NORMA / NORM / NORM / NORME								YMW
TOLLERANZA / TOLERANCE / TOLERANZ / TOLÉRANCE								-
IMBOCCO / CHAMFER / ANSCHNITT / ENTRÉE								3.5P
Dxn	D(mm)		L	l	d	k	Stock	
Pg 7 x20	12.5	11.4	70	20	9	7	●	
Pg 9 x18	15.2	14	70	22	12	9	●	
Pg 11 x18	18.6	17.25	80	22	14	11	●	
Pg 13.5x18	20.4	19	80	22	16	12	●	
Pg 16 x18	22.5	21.25	80	22	18	14.5	●	
Pg 21 x16	28.3	27	90	22	20	16	●	
Pg 29 x16	37.0	35.5	110	25	28	22	●	
Pg 36 x16	47.0	45.5	125	25	36	29	△	
Pg 42 x16	54.0	52.5	135	45	45	35	△	
Pg 48 x16	59.3	58	140	45	45	35	△	



Pg 7 ~ Pg 48 4

MASCHI A MACCHINA PER FORI CIECHI E PASSANTI

BLIND AND THROUGH HOLES MACHINE TAPS

MASCHINENGEWINDEBOHRER FÜR DURCHGANGS-UND GRUNDLÖCHER

TARAUDS MACHINE POUR TROUS BORGNES ET DÉBOUCHANTS

EG M, MF
JIS

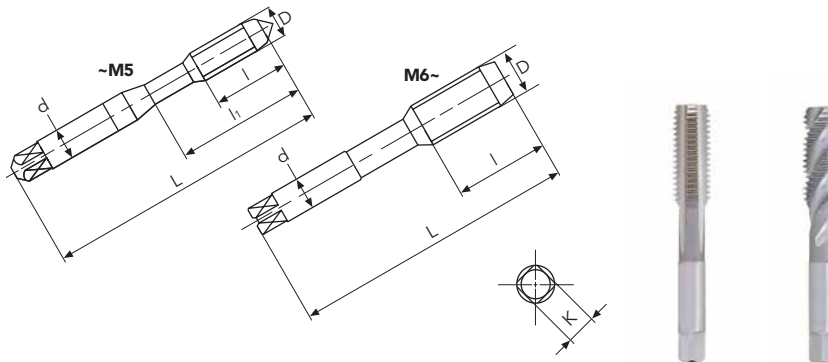

GRUPPI MATERIALE · MATERIAL GROUPS WERKSTOFFE GRUPPE · GROUPES MATIÈRE								16 17	16 17
CODICE / ITEM NO. / ARTIKEL NR. / RÉFÉRENCE								STI-HT	STI-SP
TIPO / TYPE / TYP / TYPE								HT	SP35°
MATERIALE / MATERIAL / WERKSTOFF / MATIÈRE								HSSE	HSSE
RIVESTIMENTO / COATING / BESCHICHTUNG / REVÊTEMENT								BR	BR
NORMA / NORM / NORM / NORME								JIS	JIS
TOLLERANZA / TOLERANCE / TOLERANZ / TOLÉRANCE								-	-
IMBOCCO / CHAMFER / ANSCHNITT / ENTRÉE								1.5P	2.5P
Dxp	D(mm)	Ø	L	l	l1	d	k	Stock	Stock
M 3x0.5	3.650	3.1	52	13	21	5	4	●	○
M 4x0.7	4.909	4.2	60	16	25	5.5	4.5	●	○
M 5x0.8	6.039	5.2	62	19	30	6	4.5	●	○
M 6x1	7.299	6.3	70	22		6.2	5	●	○
M 8x1.25	9.264	8.4	75	24		7	5.5	●	○
M10x1.5	11.949	10.5	82	29		8.5	6.5	●	○
M12x1.75	14.273	12.5	90	30		10.5	8	●	○
M14x2	16.598	14.5	95	32		13	10	●	○
M16x2	18.598	16.5	105	37		14	11	●	○
M18x2.5	21.248	18.8	115	38		17	13	○	○
M20x2.5	23.248	20.8	120	45		19	15	○	○
M22x2.5	25.248	22.8	125	45		20	15	○	○
M24x3	27.897	25	130	45		21	17	○	○
M10x1.25	11.624	10.4	82	29		8.5	6.5	○	○
M12x1.5	13.949	12.5	88	30		10.5	8	○	○
M12x1.25	13.624	12.5	88	30		10.5	8	○	○
M14x1.5	15.949	14.5	95	32		12.5	10	○	○
M16x1.5	17.949	16.5	100	37		14	11	○	○
M18x1.5	19.949	18.5	105	37		15	12	○	○
M20x1.5	21.949	20.5	115	38		17	13	○	○
M22x1.5	23.949	22.4	120	45		19	15	○	○
M24x1.5	25.949	24.5	125	45		20	15	○	○



M 3	3	3
M 4 ~ M14	3	4
M16 ~ M24	4	4

Usò dei maschi per filetti riportati · Usage of taps for helical coil wire hread insert
Anwendung der Gewindebohrer für Gewindeinsätze · Usage des tarauds pour filets rapportés

