

CODICE · ITEM NO. ARTIKEL NR. · RÉFÉRENCE	DESCRIZIONE · DESCRIPTION EZEICHUNG · DESCRIPTION	PAGINA · PAGE SEITE · PAGE	
5980	NPT - ANSIB94.9 STR HSSE	209	
5984X	NPT - ANSIB94.9 STR-INT HSSE OX	209	
5990	NPTF - ANSIB94.9 STR HSSE	210	
INT-PT	Rc - JIS LH-SP8° HSSE OX	211	
PT	Rc - JIS HT HSSE	211	
SP-PT	Rc - JIS XL SP25° HSSE	211	
PT-L	Rc - JIS L HT HSSE	211	
PT-XL	Rc - JIS XL HT HSSE	211	
PS	Rp - JIS HT HSSE	212	
SP-PS	Rp - JIS SP40° HSSE	212	
PS-L	Rp - JIS L HT HSSE	212	
PS-XL	Rp - JIS XL HT HSSE	212	

- MASCHI A MACCHINA PER FORI CIECHI E PASSANTI**
- BLIND AND THROUGH HOLES MACHINE TAPS**
- MASCHINENGEWINDEBOHRER FÜR DURCHGANGS-UND GRUNDLÖCHER**
- TARAUDS MACHINE POUR TROUS BORGNES ET DÉBOUCHANTS**

NPT
ANSI B94.9

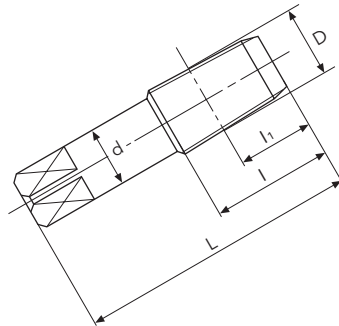

GRUPPI MATERIALE · MATERIAL GROUPS		1	2	3	4	5	1	2	3	4	
WERKSTOFFE GRUPPE · GROUPES MATIÈRE		12	13	14	17	8	9	10			
CODICE / ITEM NO. / ARTIKEL NR. / RÉFÉRENCE		5980					5984X				
TIPO / TYPE / TYP / TYPE		STR					STR-INT				
MATERIALE / MATERIAL / WERKSTOFF / MATIÈRE		HSSE					HSSE				
RIVESTIMENTO / COATING / BESCHICHTUNG / REVÊTEMENT		BR					OX				
NORMA / NORM / NORM / NORME		ANSI B94.9					ANSI B94.9				
TOLLERANZA / TOLERANCE / TOLERANZ / TOLÉRANCE		-					-				
IMBOCCO / CHAMFER / ANSCHNITT / ENTRÉE		3P					3P				
D	n		L	l	l1	d	k	Stock	Stock		
NPT 1/16	27		54	17.45	12	7.937	5.943	●	●		
NPT 1/8	27		54	19.05	12.05	11.112	8.331	●	●		
NPT 1/4	18		61.9	27	17.45	14.287	10.693	●	●		
NPT 3/8	18		65.1	27	17.65	17.78	13.487	●	●		
NPT 1/2	14		79.4	34.95	22.85	17.462	13.081	●	●		
NPT 3/4	14		82.55	34.95	22.95	23.02	17.246	●	●		
NPT 1	11.5		95.25	44.45	27.4	28.575	21.412	●	●		
NPT 1 1/4	11.5		101.6	44.45	28.1	33.337	24.993	○	○		
NPT 1 1/2	11.5		107.95	44.45	28.4	38.1	28.575	○	○		
NPT 2	11.5		114.3	44.45	28	47.625	35.712	○	○		



NPT 1/16 ~ NPT 1/2	4	5
NPT 3/4 ~ NPT 1 1/4	5	5
NPT 1 1/2 ~ NPT 2	7	7

 **MASCHI A MACCHINA PER FORI CIECHI E PASSANTI**

 **BLIND AND THROUGH HOLES MACHINE TAPS**

 **MASCHINENGEWINDEBOHRER FÜR DURCHGANGS-UND GRUNDLÖCHER**

 **TARAUDS MACHINE POUR TROUS BORGNES ET DÉBOUCHANTS**

NPTF

ANSI B94.9

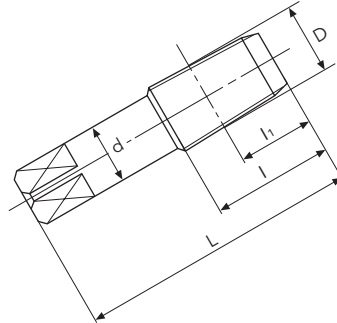

GRUPPI MATERIALE - MATERIAL GROUPS		WERKSTOFFE GRUPPE - GROUPES MATIÈRE		1 2 3 4 5				
CODICE / ITEM NO. / ARTIKEL NR. / RÉFÉRENCE		TIPO / TYPE / TYP / TYPE		12 13 14 17				
5990		STR						
MATERIALE / MATERIAL / WERKSTOFF / MATIÈRE		HSSE						
RIVESTIMENTO / COATING / BESCHICHTUNG / REVÊTEMENT		BR						
NORMA / NORM / NORM / NORME		ANSI B94.9						
TOLLERANZA / TOLERANCE / TOLERANZ / TOLÉRANCE		-						
IMBOCCO / CHAMFER / ANSCHNITT / ENTRÉE		3P						
D	n		L	l	l1	d	k	Stock
NPTF 1/16	27	page 45	54	17.45	12	7.937	5.943	●
NPTF 1/8	27		54	19.05	12.05	11.112	8.331	●
NPTF 1/4	18		61.9	27	17.45	14.287	10.693	●
NPTF 3/8	18		65.1	27	17.65	17.78	13.487	●
NPTF 1/2	14		79.4	34.95	22.85	17.462	13.081	●
NPTF 3/4	14		82.55	34.95	22.95	23.02	17.246	●
NPTF 1	11.5		95.25	44.45	27.4	28.575	21.412	●



NPTF 1/16 - NPTF 1/2	4
NPTF 3/4 - NPTF 1	5

- MASCHI A MACCHINA PER FORI CIECHI E PASSANTI**
- BLIND AND THROUGH HOLES MACHINE TAPS**
- MASCHINENGEWINDEBOHRER FÜR DURCHGANGS-UND GRUNDLÖCHER**
- TARAUDS MACHINE POUR TROUS BORGNES ET DÉBOUCHANTS**

Rc
JIS

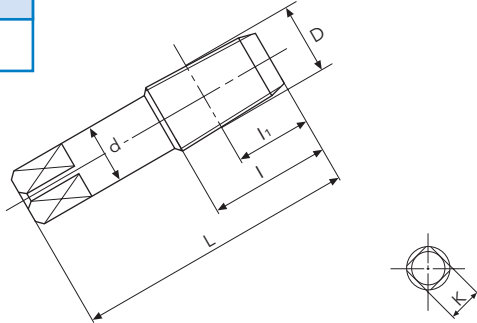

L100

L150



GRUPPI MATERIALE · MATERIAL GROUPS		WERKSTOFFE GRUPPE · GROUPES MATIÈRE		1 2 3 4		1 2 3 4 5		1 2 3		1 2 3 4 5		1 2 3 4 5	
				8 9 10		12 13 14 17		4 14 17		12 13 14 17		12 13 14 17	
CODICE / ITEM NO. / ARTIKEL NR. / RÉFÉRENCE		INT-PT		PT		SP-PT		PT-L		PT-XL			
TIPO / TYPE / TYP / TYPE		LHSP8°		HT		SP25°		HT		HT			
MATERIALE / MATERIAL / WERKSTOFF / MATIÈRE		HSSE		HSSE		HSSE		HSSE		HSSE			
RIVESTIMENTO / COATING / BESCHICHTUNG / REVÊTEMENT		OX		BR		BR		BR		BR			
NORMA / NORM / NORM / NORME		JIS		JIS		JIS		JIS		JIS			
TOLLERANZA / TOLERANCE / TOLERANZ / TOLÉRANCE		-		-		-		-		-			
IMBOCCO / CHAMFER / ANSCHNITT / ENTRÉE		3P		2.5P		2.5P		2.5P		2.5P			
D	n	Ø	L	l	l1	d	k	Stock	Stock	Stock	Stock	Stock	Stock
Rc 1/8	28		55	19	13	8	6	○	●	○	●	●	●
Rc 1/4	19		62	28	21	11	9	○	●	○	●	●	●
Rc 3/8	19		65	28	21	14	11	○	●	○	●	●	●
Rc 1/2	14		80	35	25	18	14	○	●	○			●
Rc 3/4	14		85	35	25	23	17	○	●	○			○
Rc 1	11		95	45	32	26	21	○	●	○			○
Rc 1 1/4	11		105	45	32	32	26	○	○				
Rc 1 1/2	11		110	45	32	38	29	○	○				
Rc 2	11		120	50	35	46	35	△	○				

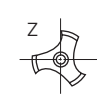

Rc 1/8 ~ Rc 3/8	5	4	3	4	4
Rc 1/2 ~ Rc 3/4	5	4	4		4
Rc 1 ~ Rc 1 1/4	5	5	4		5
Rc 1 1/2 ~ Rc 2	7	6			

page 45

🇮🇹 MASCHI A MACCHINA PER FORI CIECHI E PASSANTI

🇬🇧 BLIND AND THROUGH HOLES MACHINE TAPS

🇩🇪 MASCHINENGEWINDEBOHRER FÜR DURCHGANGS-UND GRUNDLÖCHER

🇫🇷 TARAUDS MACHINE POUR TROUS BORGNES ET DÉBOUCHANTS

Rp
JIS

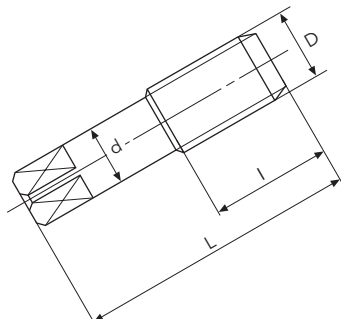

L100



L150



GRUPPI MATERIALE · MATERIAL GROUPS		1 2 3 4 5					1 2 3			1 2 3 4 5					1 2 3 4 5				
WERKSTOFFE GRUPPE · GROUPES MATIÈRE		12 13 14 17					4 14 17			12 13 14 17					12 13 14 17				
CODICE / ITEM NO. / ARTIKEL NR. / RÉFÉRENCE		PS					SP-PS			PS-L					PS-XL				
TIPO / TYPE / TYP / TYPE		HT					SP40°			HT					HT				
MATERIALE / MATERIAL / WERKSTOFF / MATIÈRE		HSSE					HSSE			HSSE					HSSE				
RIVESTIMENTO / COATING / BESCHICHTUNG / REVÊTEMENT		BR					BR			BR					BR				
NORMA / NORM / NORM / NORME		JIS					JIS			JIS					JIS				
TOLLERANZA / TOLERANCE / TOLERANZ / TOLÉRANCE		-					-			-					-				
IMBOCCO / CHAMFER / ANSCHNITT / ENTRÉE		3.5P					2.5P			3.5P					3.5P				
Dxn	D(mm)	Ø	L	l	d	k	Stock	Stock	Stock	Stock	Stock	Stock	Stock	Stock	Stock	Stock			
Rp 1/8x28	9.728	8.5	55	19	8	6	●	○	●	●	●	●	●	●	●	●			
Rp 1/4x19	13.157	11.4	62	28	11	9	●	○	●	●	●	●	●	●	●	●			
Rp 3/8x19	16.662	14.9	65	28	14	11	●	○	●	●	●	●	●	●	●	●			
Rp 1/2x14	20.955	18.6	80	35	18	14	●	○	●	●	●	●	●	●	●	●			
Rp 3/4x14	26.441	24	85	35	23	17	●	○	●	●	●	●	●	●	○	○			
Rp 1 x11	33.249	30.2	95	45	26	21	●	○	●	●	●	●	●	○	○	○			
Rp 1 1/4x11	41.910	38.8	105	45	32	26	○												
Rp 1 1/2x11	47.803	44.7	110	45	38	29	○												
Rp 2 x11	59.614	56.5	120	50	46	35	○												



Rp 1/8 ~ Rp 3/8	4	3	4	4
Rp 1/2 ~ Rp 3/4	4	4		4
Rp 1 ~ Rp 1 1/4	5	4		5
Rp 1 1/2 ~ Rp 2	6			