













CODICE · ITEM NO. ARTIKEL NR. · RÉFÉRENCE	DESCRIZIONE · DESCRIPTION EZEICHUNG · DESCRIPTION	PAGINA · PAGE SEITE · PAGE	
LS-HT	M - JIS LS-HT HSSE	101	
LS-HT	MF - JIS LS-HT HSSE	102	
LS-PO	M - JIS LS-PO HSSE	101	
LS-PO	MF - JIS LS-PO HSSE	102	
LS-SP	M - JIS LS-SP 40° HSSE	101	
LS-SP	MF - JIS LS-SP 40° HSSE	102	
LS-SP-LH	M - JIS LS-SP-LH 40° HSSE	101	
LS-SP-LH	MF - JIS LS-SP-LH 40° HSSE	102	
LS-N-RS	M - JIS LS-N-RS ROLL HSSE	103	
LS-N-RZ	M - JIS LS-N-RZ ROLL HSSE	103	
LS-PF	G - JIS HT HSSE	104	
PS-L	Rp - JIS HT HSSE	105	
PS-XL	Rp - JIS HT HSSE	105	
PT-L	Rc - JIS HT HSSE	106	
PT-XL	Rc - JIS HT HSSE	106	

- MASCHI A MACCHINA - **SERIE LUNGA**
- MACHINE TAPS - **LONG**
- MASCHINENGEWINDEBOHRER - **LANG**
- TARAUDS MACHINE - **LONGS**

M
JIS

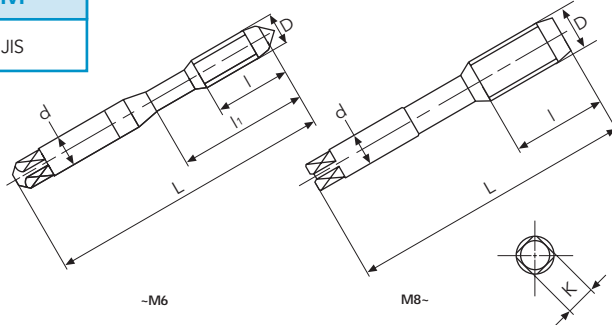

GRUPPI MATERIALE · MATERIAL GROUPS WERKSTOFFE GRUPPE · GROUPES MATIÈRE								1 2 3 4 5 12 13 14 17	1 2 3 4 16 17	1 2 3 4 14 16 17 18	1 2 3 4 14 16 17 18
CODICE / ITEM NO. / ARTIKEL NR. / RÉFÉRENCE								LS-HT	LS-PO	LS-SP	LS-SP-LH
TIPO / TYPE / TYP / TYPE								HT	PO	SP40°	SP-LH40°
MATERIALE / MATERIAL / WERKSTOFF / MATIÈRE								HSSE	HSSE	HSSE	HSSE
RIVESTIMENTO / COATING / BESCHICHTUNG / REVÊTEMENT								BR	BR	BR	BR
NORMA / NORM / NORM / NORME								JIS	JIS	JIS	JIS
TOLLERANZA / TOLERANCE / TOLERANZ / TOLÉRANCE								P CLASS*	P CLASS*	P CLASS*	P CLASS*
IMBOCCO / CHAMFER / ANSCHNITT / ENTRÉE								1.5P	5P	2.5P	2.5P
D	p	Ø	L	l	l1	d	k	Stock	Stock	Stock	Stock
M 3	0.5	2.5	100	11	18	4	3.2	○ (P1)	● (P2)	● (P1)	○ (P1)
M 4	0.7	3.3	100	13	21	5	4	○ (P2)	● (P2)	● (P2)	○ (P2)
M 5	0.8	4.2	100	16	25	5.5	4.5	○ (P2)	● (P2)	● (P2)	○ (P2)
M 6	1	5	100	19	30	6	4.5	○ (P2)	● (P2)	● (P2)	○ (P2)
M 8	1.25	6.8	100	22		6.2	5	○ (P2)	● (P3)	● (P2)	
M 3	0.5	2.5	150	11	18	4	3.2	○ (P1)	● (P2)	● (P1)	
M 4	0.7	3.3	150	13	21	5	4	○ (P2)	● (P2)	● (P2)	
M 5	0.8	4.2	150	16	25	5.5	4.5	○ (P2)	● (P2)	● (P2)	
M 6	1	5	150	19	30	6	4.5	○ (P2)	● (P2)	● (P2)	○ (P2)
M 8	1.25	6.8	150	22		6.2	5	○ (P2)	● (P3)	● (P2)	○ (P2)
M10	1.5	8.5	150	24		7	5.5	○ (P2)	● (P3)	● (P2)	○ (P2)
M12	1.75	10.3	150	29		8.5	6.5	○ (P2)	● (P4)	● (P2)	○ (P2)
M14	2	12	150	30		10.5	8	○ (P2)	● (P4)	● (P2)	○ (P2)
M16	2	14	150	32		12.5	10	○ (P2)	● (P4)	● (P2)	○ (P2)
M18	2.5	15.5	150	37		14	11	○ (P3)	● (P4)	● (P3)	
M20	2.5	17.5	150	37		15	12	○ (P3)	● (P4)	● (P3)	
M10	1.5	8.5	200	24		7	5.5	○ (P2)	● (P3)	● (P2)	
M12	1.75	10.3	200	29		8.5	6.5	○ (P2)	● (P4)	● (P2)	
M14	2	12	200	30		10.5	8	○ (P2)	● (P4)	● (P2)	
M16	2	14	200	32		12.5	10	○ (P2)	● (P4)	● (P2)	
M18	2.5	15.5	200	37		14	11	○ (P3)	● (P4)	● (P3)	
M20	2.5	17.5	200	37		15	12	○ (P3)	● (P4)	● (P3)	
M22	2.5	19.5	200	38		17	13	○ (P3)	● (P4)	● (P3)	
M24	3	21	200	45		19	15	○ (P3)	● (P4)	● (P3)	

*P CLASS page 47



M 3 ~ M 6	3	3	3	3
M 8 ~ M16	4	3	3	3
M18 ~ M24	4	3	4	4

MASCHI A MACCHINA - **SERIE LUNGA**

MACHINE TAPS - **LONG**

MASCHINENGEWINDEBOHRER - **LANG**

TARAUDS MACHINE - **LONGS**

MF
JIS

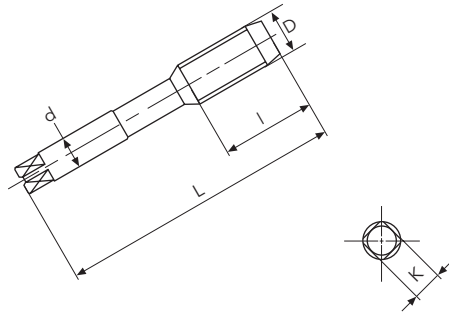

GRUPPI MATERIALE · MATERIAL GROUPS		1 2 3 4 5					1 2 3			1 2 3 4				1 2 3 4			
WERKSTOFFE GRUPPE · GROUPES MATIÈRE		12 13 14 17					4 16 17			14 16 17 18				14 16 17 18			
CODICE / ITEM NO. / ARTIKEL NR. / RÉFÉRENCE		LS-HT					LS-PO			LS-SP				LS-SP-LH			
TIPO / TYPE / TYP / TYPE		HT					PO			SP40°				SP-LH40°			
MATERIALE / MATERIAL / WERKSTOFF / MATIÈRE		HSSE					HSSE			HSSE				HSSE			
RIVESTIMENTO / COATING / BESCHICHTUNG / REVÊTEMENT		BR					BR			BR				BR			
NORMA / NORM / NORM / NORME		JIS					JIS			JIS				JIS			
TOLLERANZA / TOLERANCE / TOLERANZ / TOLÉRANCE		P CLASS*					P CLASS*			P CLASS*				P CLASS*			
IMBOCCO / CHAMFER / ANSCHNITT / ENTRÉE		1.5P					5P			2.5P				2.5P			
D	p	Ø	L	l	d	k	Stock	Stock	Stock	Stock	Stock	Stock	Stock	Stock	Stock	Stock	
M10	1.25	8.8	150	24	7	5.5	○ (P2)	● (P3)	● (P2)	○ (P2)							
M12	1.5	10.5	150	29	8.5	6.5	○ (P2)	● (P3)	● (P2)	○ (P2)							
M12	1.25	10.8	150	29	8.5	6.5	○ (P2)	● (P4)	● (P2)	○ (P2)							
M14	1.5	12.5	150	30	10.5	8	○ (P2)	● (P3)	● (P2)	○ (P2)							
M16	1.5	14.5	150	32	12.5	10	○ (P2)	● (P3)	● (P2)	○ (P2)							
M18	1.5	16.5	150	37	14	11	○ (P2)	○ (P4)	○ (P2)								
M20	1.5	18.5	150	37	15	12	○ (P3)	○ (P4)	○ (P3)								
M22	1.5	20.5	150	38	17	13	○ (P3)	○ (P4)	○ (P3)								
M24	1.5	22.5	150	45	19	15	○ (P3)	○ (P4)	○ (P3)								
M12	1.5	10.5	200	24	8.5	6.5	○ (P2)	○ (P3)	○ (P2)								
M12	1.25	10.8	200	29	8.5	6.5	○ (P2)	○ (P4)	○ (P2)								
M14	1.5	12.5	200	30	10.5	8	○ (P2)	○ (P3)	○ (P2)								
M16	1.5	14.5	200	32	12.5	10	○ (P2)	○ (P3)	○ (P2)								
M18	1.5	16.5	200	37	14	11	○ (P2)	○ (P4)	○ (P2)								
M20	1.5	18.5	200	37	15	12	○ (P3)	○ (P4)	○ (P3)								
M22	1.5	20.5	200	38	17	13	○ (P3)	○ (P4)	○ (P3)								
M24	1.5	22.5	200	45	19	15	○ (P3)	○ (P4)	○ (P3)								

*P CLASS page 47



M10 ~ M16	4	3	3	3
M18 ~ M24	4	3	4	4

🇮🇹 MASCHI A RULLARE - **SERIE LUNGA**

🇬🇧 ROLL TAPS - **LONG**

🇩🇪 MASCHINENGEWINDEFORMER - **LANG**

🇫🇷 TARAUDS À REFOULER - **LONGS**

M
JIS

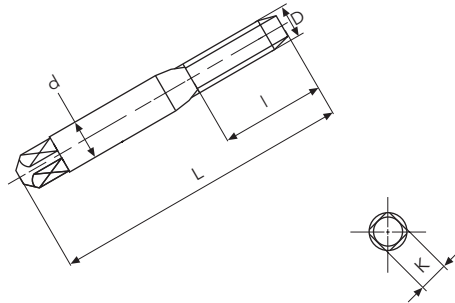

MATERIALI NON FERROSI · NON FERROUS MATERIALS
NICHTEISEN MATERIAL · MATIÈRES NON-FERREUSES



ACCIAIO · STEEL · STAHL · ACIER



GRUPPI MATERIALE · MATERIAL GROUPS WERKSTOFFE GRUPPE · GROUPES MATIÈRE		16 17 18 19	1 2 3 9					
CODICE / ITEM NO. / ARTIKEL NR. / RÉFÉRENCE		LS-N-RS	LS-N-RZ					
TIPO / TYPE / TYP / TYPE		N-RS	N-RZ					
MATERIALE / MATERIAL / WERKSTOFF / MATIÈRE		HSSE	HSSE					
RIVESTIMENTO / COATING / BESCHICHTUNG / REVÊTEMENT		NI	OX					
NORMA / NORM / NORM / NORME		JIS	JIS					
TOLLERANZA / TOLERANCE / TOLERANZ / TOLÉRANCE		G CLASS*	G CLASS*					
IMBOCCO / CHAMFER / ANSCHNIITT / ENTRÉE		2P	2P					
D	p	∅	L	l	d	k	Stock	Stock
M 3	0.5	2.75	100	11	4	3.2	● (G6)	● (G7)
M 4	0.7	3.69	100	13	5	4	● (G7)	● (G7)
M 5	0.8	4.64	100	16	5.5	4.5	● (G7)	● (G7)
M 6	1	5.55	100	19	6	4.5	● (G8)	● (G8)
M 6	1	5.55	150	19	6	4.5	● (G8)	● (G8)

*G CLASS page 52

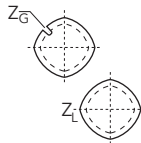

M 3 ~ M 6	1	4
M 3 ~ M 6	4	4

MASCHI A MACCHINA - **SERIE LUNGA**

MACHINE TAPS - **LONG**

MASCHINENGEWINDEBOHRER - **LANG**

TARAUDS MACHINE - **LONGS**

G
JIS

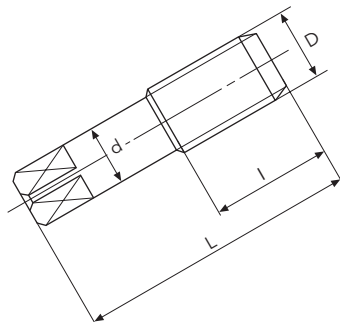

GRUPPI MATERIALE · MATERIAL GROUPS		1 2 3 4 5					
WERKSTOFFE GRUPPE · GROUPES MATIÈRE		12 13 14 17					
CODICE / ITEM NO. / ARTIKEL NR. / RÉFÉRENCE		LS-PF					
TIPO / TYPE / TYP / TYPE		HT					
MATERIALE / MATERIAL / WERKSTOFF / MATIÈRE		HSSE					
RIVESTIMENTO / COATING / BESCHICHTUNG / REVÊTEMENT		BR					
NORMA / NORM / NORM / NORME		JIS					
TOLLERANZA / TOLERANCE / TOLERANZ / TOLÉRANCE							
IMBOCCO / CHAMFER / ANSCHNITT / ENTRÉE		3.5P					
Dxn	D(mm)	Ø	L	l	d	k	Stock
G 1/8x28	9.147	8.75	150	19	8	6	●
G 1/4x19	12.301	11.8	150	28	11	9	●
G 3/8x19	15.806	15.25	150	28	14	11	●
G 1/2x14	19.793	19	150	35	18	14	●



G 1/8 - G 1/2	4
---------------	---

🇮🇹 MASCHI A MACCHINA - **SERIE LUNGA**

🇬🇧 MACHINE TAPS - **LONG**

🇩🇪 MASCHINENGEWINDEBOHRER - **LANG**

🇫🇷 TARAUDS MACHINE - **LONGS**

Rp
JIS

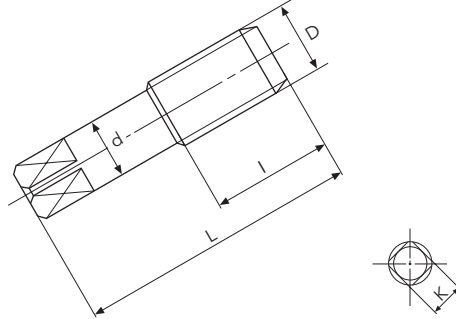

GRUPPI MATERIALE · MATERIAL GROUPS							1	2	3	4	5	1 2 3 4 5				
WERKSTOFFE GRUPPE · GROUPES MATIÈRE							12	13	14	17	12	13	14	17		
CODICE / ITEM NO. / ARTIKEL NR. / RÉFÉRENCE							PS-L					PS-XL				
TIPO / TYPE / TYP / TYPE							HT					HT				
MATERIALE / MATERIAL / WERKSTOFF / MATIÈRE							HSSE					HSSE				
RIVESTIMENTO / COATING / BESCHICHTUNG / REVÊTEMENT							BR					BR				
NORMA / NORM / NORM / NORME							JIS					JIS				
TOLLERANZA / TOLERANCE / TOLERANZ / TOLÉRANCE							-					-				
IMBOCCO / CHAMFER / ANSCHNITT / ENTRÉE							3.5P					3.5P				
Dxn	D(mm)	Ø	L	l	d	k	Stock					Stock				
Rp 1/8x28	9.728	8.5	100	19	8	6	●									
Rp 1/4x19	13.157	11.4	100	28	11	9	●									
Rp 3/8x19	16.662	14.9	100	28	14	11	●									
Rp 1/8x28	9.728	8.5	150	19	8	6						●				
Rp 1/4x19	13.157	11.4	150	28	11	9						●				
Rp 3/8x19	16.662	14.9	150	28	14	11						●				
Rp 1/2x14	20.955	18.6	150	35	18	14						●				
Rp 3/4x14	26.441	24	150	35	23	17						○				
Rp 1 x11	33.249	30.2	150	45	26	21						○				



Rp 1/8 ~ Rp 3/4	4	4
Rp 1	5	5

🇮🇹 MASCHI A MACCHINA - **SERIE LUNGA**

🇬🇧 MACHINE TAPS - **LONG**

🇩🇪 MASCHINENGEWINDEBOHRER - **LANG**

🇫🇷 TARAUDS MACHINE - **LONGS**

Rc
JIS

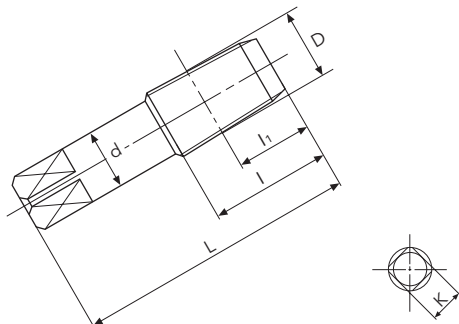

GRUPPI MATERIALE · MATERIAL GROUPS								1	2	3	4	5	1					2	3	4	5
WERKSTOFFE GRUPPE · GROUPES MATIÈRE								12	13	14	17	12	13	14	17						
CODICE / ITEM NO. / ARTIKEL NR. / RÉFÉRENCE								PT-L					PT-XL								
TIPO / TYPE / TYP / TYPE								HT					HT								
MATERIALE / MATERIAL / WERKSTOFF / MATIÈRE								HSSE					HSSE								
RIVESTIMENTO / COATING / BESCHICHTUNG / REVÊTEMENT								BR					BR								
NORMA / NORM / NORM / NORME								JIS					JIS								
TOLLERANZA / TOLERANCE / TOLERANZ / TOLÉRANCE								-					-								
IMBOCCO / CHAMFER / ANSCHNITT / ENTRÉE								2.5P					2.5P								
D	n	Ø	L	l	l1	d	k	Stock					Stock								
Rc 1/8	28	page 45	100	19	13	8	6	●													
Rc 1/4	19		100	28	21	11	9	●													
Rc 3/8	19		100	28	21	14	11	●													
Rc 1/8	28		150	19	13	8	6							●							
Rc 1/4	19		150	28	21	11	9							●							
Rc 3/8	19		150	28	21	14	11							●							
Rc 1/2	14		150	35	25	18	14							●							
Rc 3/4	14		150	35	25	23	17							○							
Rc 1	11		150	45	32	26	21							○							



Rc 1/8 ~ Rc 3/4	4	4
Rc 1	5	5