







CODICE · ITEM NO. ARTIKEL NR. · RÉFÉRENCE	DESCRIZIONE · DESCRIPTION EZEICHUNG · DESCRIPTION	PAGINA · PAGE SEITE · PAGE	
MC-HLC	M, MF - YMW NORM HSS/CO TiN	284	
MC-CSLC	M, MF - YMW NORM CARBIDE TiAIN	284	
MC-HLC	G, Rp - YMW NORM HSS/CO TiN	285	
MC-CSLC	G, Rp - YMW NORM CARBIDE TiAIN	285	
MC-HLC	Rc - YMW NORM HSS/CO TiN	285	
MC-CSLC	Rc - YMW NORM CARBIDE TiAIN	285	

- FRESE A FILETTARE
- THREAD MILLS
- GEWINDEFÄSER
- FRAISES À FILETER

M, MF
 YMW NORM

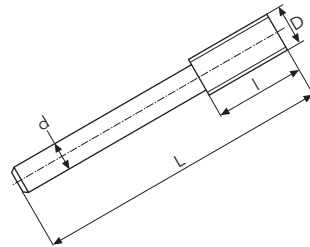

GRUPPI MATERIALE · MATERIAL GROUPS								page 282	page 282
WERKSTOFFE GRUPPE · GROUPES MATIÈRE								page 282	page 282
CODICE / ITEM NO. / ARTIKEL NR. / RÉFÉRENCE								MC-HLC	MC-CSLC
TIPO / TYPE / TYP / TYPE								STR	LOSP15°
MATERIALE / MATERIAL / WERKSTOFF / MATIÈRE								HSS/Co	CARBIDE
RIVESTIMENTO / COATING / BESCHICHTUNG / REVÊTEMENT								TiN	TiAlN
NORMA / NORM / NORM / NORME								YMW	YMW
D	p	Ømin	L	l	l1	d	Z	Stock	Stock
mm. 3.5	0.75	5	50		8	6	3		△
mm. 3.5	0.8	5	50		8	6	3		△
mm. 4	1	6	60		12	6	3		△
mm. 6	0.5	8	70		16	8	3		△
mm. 6	1	8	70		16	8	3		○
mm. 6	1.25	8	70		16	8	3		○
mm. 7.5	1.25	10	70		20	8	3		△
mm. 7.5	1.5	10	70		20	8	3		○
mm. 8	0.5	10	70		20	8	3		△
mm. 8	1	10	70		20	8	3		△
mm. 9	1.25	12	90		24	10	4		○
mm. 9	1.75	12	90		24	10	4		○
mm.10	0.5	14	90		25	10	4		△
mm.10	1	14	90	20	25	10	4	○	○
mm.10	1.5	14	90	20	25	10	4	○	○
mm.10	2	14	90		25	10	4		○
mm.12	1	17	100	25	30	12	4	○	○
mm.12	1.5	17	100	25	30	12	4	○	○
mm.12	2	17	100	25	30	12	4	○	○
mm.16	1	23	110	30		16	4	○	○
mm.16	1.5	23	110	30	40	16	4	○	○
mm.16	2	23	110	30	40	16	4	○	○
mm.16	2.5	23	110	30	40	16	4	○	○
mm.20	1	28	140	50		20	5	○	○
mm.20	1.5	28	140	50	50	20	5	○	○
mm.20	2	28	140	50	50	20	5	○	○
mm.20	3	28	140	50	50	20	5	○	○
mm.20	3.5	28	140	50		20	5	○	○
mm.25	1	36	160	50		20	6	○	○
mm.25	1.5	36	160	50		20	6	○	○
mm.25	2	36	160	50		20	6	○	○
mm.25	3	36	160	50		20	6	○	○
mm.25	3.5	36	160	50		20	6	○	○
mm.32	1.5	45	200	50		25	6	○	○
mm.32	2	45	200	50		25	6	○	○
mm.32	3	45	200	50		25	6	○	○

- FRESE A FILETTARE**
- THREAD MILLS**
- GEWINDEFÄSER**
- FRAISES À FILETER**

G, Rp

YMW NORM

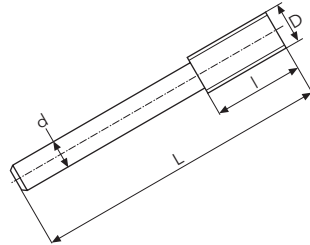

GRUPPI MATERIALE · MATERIAL GROUPS WERKSTOFFE GRUPPE · GROUPES MATIÈRE								page 282	page 282
CODICE / ITEM NO. / ARTIKEL NR. / RÉFÉRENCE								MC-HLC	MC-CSLC
TIPO / TYPE / TYP / TYPE								STR	LOSP15°
MATERIALE / MATERIAL / WERKSTOFF / MATIÈRE								HSS/Co	CARBIDE
RIVESTIMENTO / COATING / BESCHICHTUNG / REVÊTEMENT								TiN	TiAlN
NORMA / NORM / NORM / NORME								YMW	YMW
D	n	Ømin	L	l	l1	d	Z	Stock	Stock
mm. 6.5	28	1/8	70		10	8	3		○
mm. 8	19	1/4	70		15	8	3		○
mm.10	19	3/8	70	15		10	4	○	
mm.12	14	1/2	80	20	20	12	4	○	○
mm.16	11	3/4	90		26	16	4		○
mm.20	11	1	100	30		20	5	○	
mm.20	11	1	110		30	20	5		○
mm.32	11	2 1/2	200	50		25	6	○	

Rc

YMW NORM

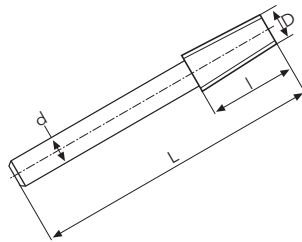

D	n	Ømin	L	l	l1	d	Z	Stock	Stock
mm. 6.5	28	1/8	70		10	8	3		○
mm. 8	19	1/4	70		15	8	3		○
mm.10	19	3/8	70	15		10	4	○	
mm.12	14	1/2	80	20	20	12	4	○	○
mm.16	11	3/4	90		26	16	4		○
mm.20	11	1	100	30		20	5	○	
mm.20	11	1	110		30	20	5		○
mm.32	11	2 1/2	200	50		25	6	○	